

Installation / Drawer Rails

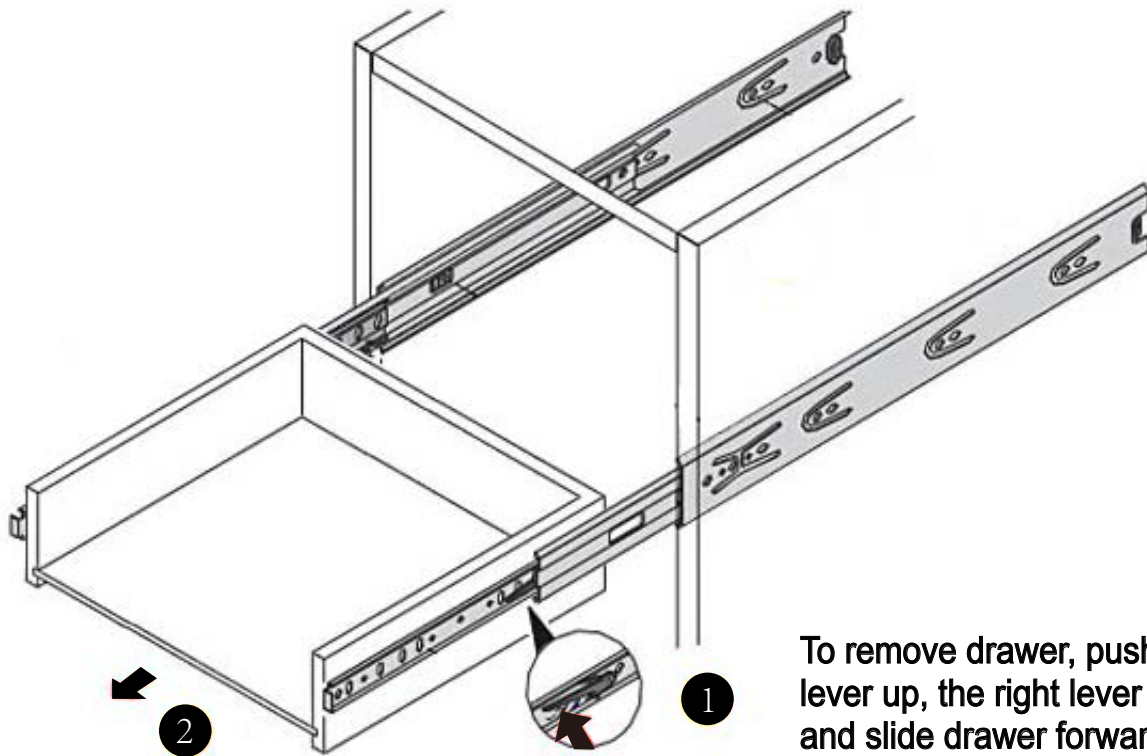

To remove drawer, push the left lever up, the right lever down, and slide drawer forward.

To install drawer, make sure to pull the middle rail forward, as shown in close up.

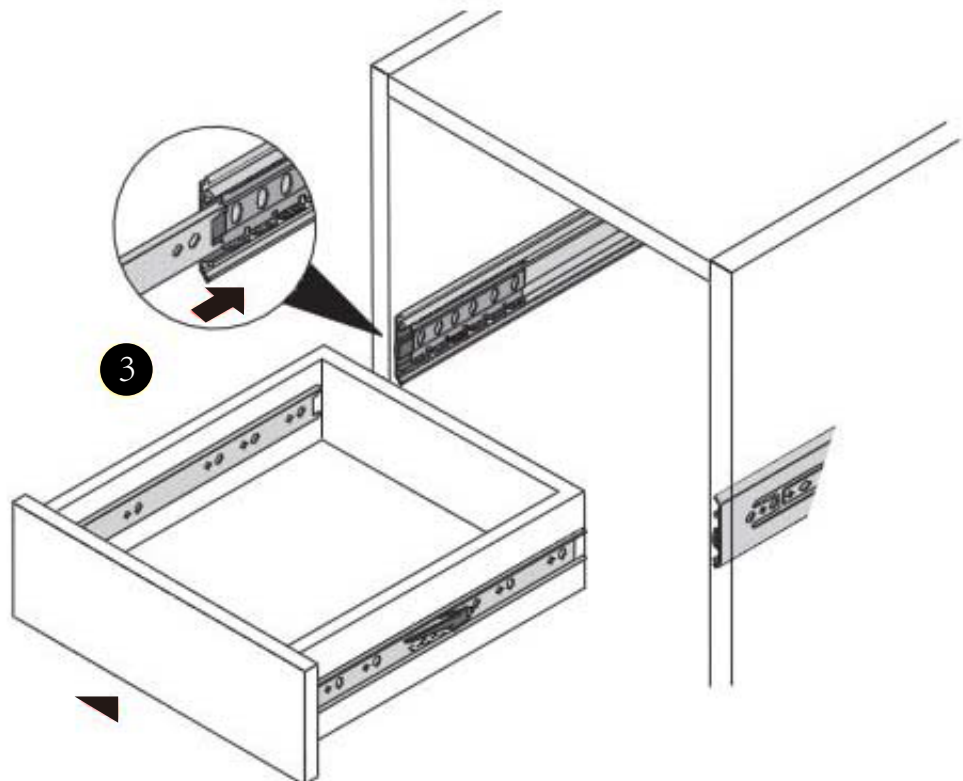

Supporting pedestal

Before installing the pedestal, remove the drawers according to « Instruction / Drawer Rails » .

If the underside of the worksurface panel has **NO HOLES(?)** as shown in figure **A**, Please use the 6 provided **WOOD SCREWS** to attach the pedestal. Secure the Pedestal by the 6 smaller **Screw** holes in the Pedestal.

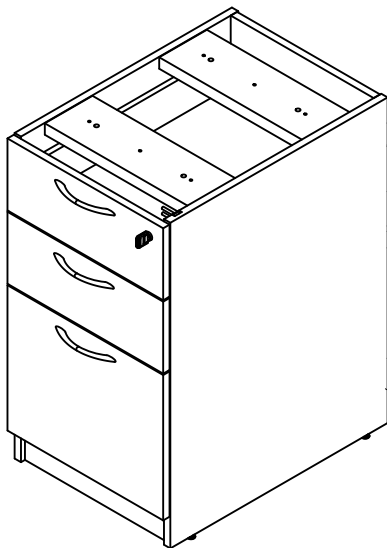
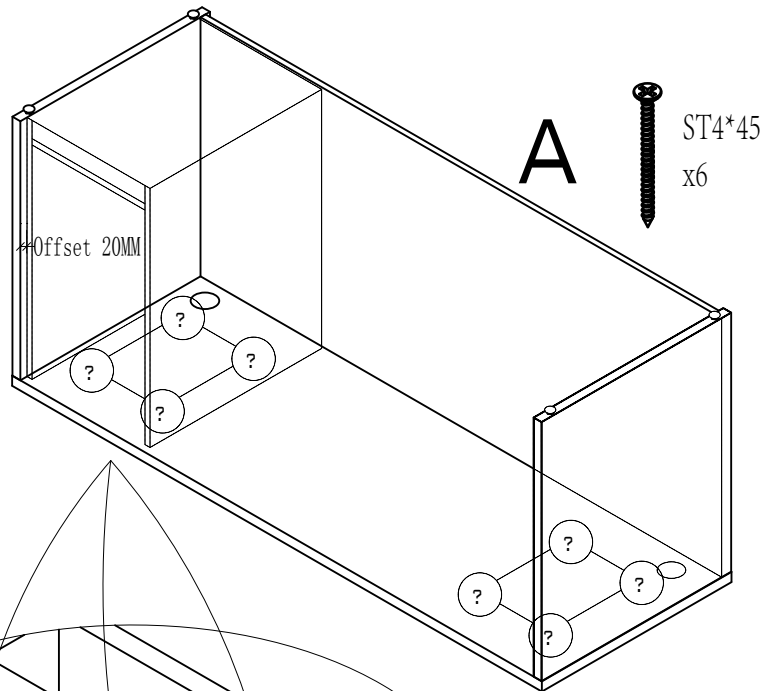

If the underside of the worksurface panel has **BOLT HOLES** as shown in figure **B**, Please use the 4 provided **BOLTS & WASHERS** to attach the pedestal to the left or right side of the panel. Secure the Pedestal by the 4 Larger **BOLT** holes in the Pedestal.

